

## Ordering data Type 01 - spare parts

Inserts and guide pads not included - please order separately

Drill-Ø mm	Insert		Guide pads
	1x	1x (alternative)	2x
12.00	01-0675-321	-	01-0500-410/12
12.50	01-0675-321	-	01-0500-410/12
12.70	01-0685-321	-	01-0504-410/12
13.00	01-0675-321	-	01-0500-410/12
13.50	01-0775-321	01-0775-311	01-0500-410/13
14.00	01-0775-321	01-0775-311	01-0500-410/13
14.50	01-0775-321	01-0775-311	01-0500-410/13
15.00	01-0775-321	01-0775-311	01-0500-410/13
15.50	01-0905-321	01-0905-311	01-0500-410/15
16.00	01-0905-321	01-0905-311	01-0500-410/15
16.25	01-0917-321	01-0917-311	01-0505-410/15
16.50	01-0905-321	01-0905-311	01-0500-410/15
17.00	01-0905-321	01-0905-311	01-0500-410/15
17.50	01-0905-321	01-0905-311	01-0500-410/15
18.00	01-1810-310	01-1810-320	01-1800-410-D18.00
18.50	01-1820-310	01-1820-320	01-1800-410-D18.50
19.00	01-1910-310	01-1910-320	01-1900-410-D19.00
19.05	01-1910-310	01-1910-320	01-1900-410-D19.05
19.50	01-1920-310	01-1920-320	01-1900-410-D19.50
20.00	01-2010-310	01-2010-320	01-2000-410-D20.00
20.50	01-2020-310	01-2020-320	01-2000-410-D20.50
21.00	01-2110-310	01-2110-320	01-2100-410-D21.00
22.00	01-2210-310	01-2210-320	01-2200-410-D22.00
23.00	01-2310-310	01-2310-320	01-2300-410-D23.00
24.00	01-2410-310	01-2410-320	01-2400-410-D24.00
25.00	01-2510-310	01-2510-320	01-2500-410-D25.00
25.40	01-2510-310	01-2510-320	01-2500-410-D25.40
26.00	01-2610-310	01-2610-320	01-2600-410-D26.00
27.00	01-2710-310	01-2710-320	01-2700-410-D27.00
28.00	01-2810-310	01-2810-320	01-2800-410-D28.00
29.00	01-2910-310	01-2910-320	01-2900-410-D29.00
30.00	01-3010-310	01-3010-320	01-3000-410-D30.00
31.00	01-3110-310	01-3110-320	01-3100-410-D31.00
31.75	01-3120-310	01-3120-320	01-3100-410-D31.75
32.00	01-3210-310	01-3210-320	01-3200-410-D32.00
33.00	01-3310-310	01-3310-320	01-3300-410-D33.00
34.00	01-3410-310	01-3410-320	01-3400-410-D34.00
35.00	01-3510-310	01-3510-320	01-3500-410-D35.00
38.00	01-3810-310	-	01-3800-410-D38.00
38.10	01-3810-310	-	01-3800-410-D38.10
40.00	01-4010-310	-	01-4000-410-D40.00

Drill-Ø mm	Screw for insert (1x)	
	Screw	Size
12.00 - 13.00	21-0200-860	M2.5x4.7-TX8
13.50 - 17.50	22-0610-840	M2.5x5.9-TX8
18.00 - 18.50	21-0100-830	M3x6.9-TX9
19.00 - 23.00	22-0600-830	M3x8.4-TX9
24.00 - 25.40	21-0400-830	M4x9-TX15
26.00 - 29.00	22-0900-830	M4x11-TX15
30.00 - 35.00	22-1200-830	M5x12.5-TX20
38.00 - 40.00	22-1500-830	M6x14-TX25

Drill-Ø mm	Screw for guide pad (2x)	
	Screw	Size
12.00 - 17.50	01-1300-840	M2.2x4-TX7
18.00 - 19.50	21-0200-860	M2.5x4.7-TX8
20.00 - 23.00	22-0610-840	M2.5x5.9-TX8
24.00 - 29.00	22-0600-820	M2.5x8.2-TX8
30.00 - 33.00	22-0800-840	M3x8.2-TX9
34.00 - 40.00	22-1200-840	M3.5x11.4-TX15

Drill-Ø mm	Guide pad end stop and screw (2x)		
	End stop	Screw	Size
12.00 - 17.50	01-0500-150	01-1300-840	M2.2x4-TX7
18.00 - 23.00	DIN 7984 M3x3	-	M3x3-S2.0
24.00 - 33.00	DIN 7984 M4x4	-	M4x4-S2.5
34.00 - 38.10	DIN 7984 M5x5	-	M5x5-S3.0
40.00 - 40.00	DIN 7984 M6x6	-	M6x6-S4.0

Drill-Ø mm	Stop plate and screw (1x)		
	Stop plate	Screw	Size
12.00 - 17.50	-	-	-
18.00 - 23.00	01-2050-610-S...	01-0200-860	M2.5x4.3-TX8
24.00 - 35.00	01-2400-610-S...	21-0200-860	M2.5x4.7-TX8
38.00 - 40.00	01-3750-610-S...	21-0600-860	M3x6.7-TX9

Torx-Size	Driver
TX7	01-1300-945
TX8	22-0600-925
TX9	22-0600-935
TX15	22-0900-935
TX20	22-1200-935
TX25	22-1500-935

## Ordering data Type 01 - stock program

Inserts and guide pads not included - please order separately

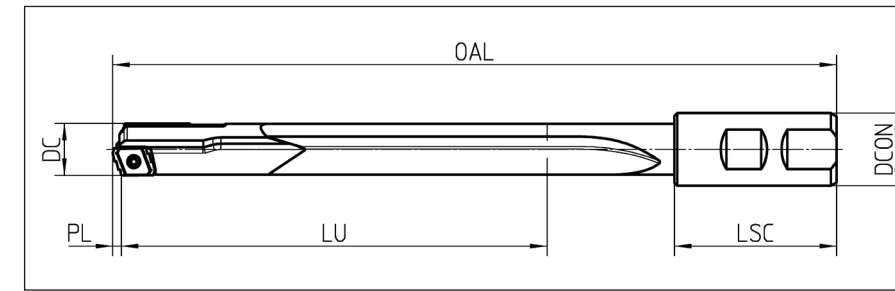

Part No.	Drill-Ø	Drilling depth		Point	Length	Driver Weldon		
	DC mm	ULDR L/D	LU mm	PL mm	OAL mm	DCON mm	LSC mm	Order No.
501100001	12.00	10	120	3	245	25	56	ZH25-22
501100002	12.00	15	180	3	305	25	56	ZH25-22
501100003	12.00	25	300	3	425	25	56	ZH25-22
501100004	12.00	35	420	3	545	25	56	ZH25-22
501100005	12.50	10	125	3	250	25	56	ZH25-22
501100006	12.50	15	188	3	315	25	56	ZH25-22
501100007	12.50	25	313	3	440	25	56	ZH25-22
501100008	12.50	35	438	3	570	25	56	ZH25-22
501100009	12.70	10	127	3	250	25	56	ZH25-22
501100010	12.70	15	191	3	315	25	56	ZH25-22
501100011	12.70	25	318	3	440	25	56	ZH25-22
501100012	12.70	35	445	3	570	25	56	ZH25-22
501100013	13.00	10	130	3	255	25	56	ZH25-22
501100014	13.00	15	195	3	320	25	56	ZH25-22
501100015	13.00	25	325	3	450	25	56	ZH25-22
501100016	13.00	35	455	3	580	25	56	ZH25-22
501100017	13.50	10	135	3	260	25	56	ZH25-22
501100018	13.50	15	203	3	325	25	56	ZH25-22
501100019	13.50	25	338	3	460	25	56	ZH25-22
501100020	13.50	35	473	3	595	25	56	ZH25-22
501100021	14.00	10	140	3	265	25	56	ZH25-22
501100022	14.00	15	210	3	335	25	56	ZH25-22
501100023	14.00	25	350	3	475	25	56	ZH25-22
501100024	14.00	35	490	3	615	25	56	ZH25-22
501100025	14.50	10	145	3	270	25	56	ZH25-22
501100026	14.50	15	218	3	340	25	56	ZH25-22
501100027	14.50	25	363	3	485	25	56	ZH25-22
501100028	14.50	35	508	3	630	25	56	ZH25-22
501100029	15.00	10	150	3	275	25	56	ZH25-22
501100030	15.00	15	225	3	350	25	56	ZH25-22
501100031	15.00	25	375	3	500	25	56	ZH25-22
501100032	15.00	35	525	3	650	25	56	ZH25-22
501100033	15.50	10	155	3	280	25	56	ZH25-22
501100034	15.50	15	233	3	355	25	56	ZH25-22
501100035	15.50	25	388	3	510	25	56	ZH25-22

Part No.	Drill-Ø	Drilling depth		Point	Length	Driver Weldon		
	DC mm	ULDR L/D	LU mm	PL mm	OAL mm	DCON mm	LSC mm	Order No.
501100036	15.50	35	543	3	665	25	56	ZH25-22
501100037	16.00	10	160	3	285	25	56	ZH25-22
501100038	16.00	15	240	3	370	25	56	ZH25-22
501100039	16.00	25	400	3	530	25	56	ZH25-22
501100040	16.00	35	560	3	695	25	56	ZH25-22
501100041	16.25	10	163	3	285	25	56	ZH25-22
501100042	16.25	15	244	3	370	25	56	ZH25-22
501100043	16.25	25	406	3	530	25	56	ZH25-22
501100044	16.25	35	569	3	695	25	56	ZH25-22
501100045	16.50	10	165	3	290	25	56	ZH25-22
501100046	16.50	15	248	3	370	25	56	ZH25-22
501100047	16.50	25	413	3	535	25	56	ZH25-22
501100048	16.50	35	578	3	700	25	56	ZH25-22
501100049	17.00	10	170	3	295	25	56	ZH25-22
501100050	17.00	15	255	3	380	25	56	ZH25-22
501100051	17.00	25	425	3	550	25	56	ZH25-22
501100052	17.00	35	595	3	720	25	56	ZH25-22
501100053	17.50	10	175	3	300	25	56	ZH25-22
501100054	17.50	15	263	3	385	25	56	ZH25-22
501100055	17.50	25	438	3	560	25	56	ZH25-22
501100056	17.50	35	613	3	735	25	56	ZH25-22
501100057	18.00	10	180	4	305	25	56	ZH25-22
501100058	18.00	15	270	4	395	25	56	ZH25-22
501100059	18.00	25	450	4	575	25	56	ZH25-22
501100060	18.00	35	630	4	755	25	56	ZH25-22
501100061	18.50	10	185	4	310	25	56	ZH25-22
501100062	18.50	15	278	4	405	25	56	ZH25-22
501100063	18.50	25	463	4	590	25	56	ZH25-22
501100064	18.50	35	648	4	775	25	56	ZH25-22
501100065	19.00	10	190	4	315	25	56	ZH25-22
501100066	19.00	15	285	4	410	25	56	ZH25-22
501100067	19.00	25	475	4	600	25	56	ZH25-22
501100068	19.00	35	665	4	790	25	56	ZH25-22
501100069	19.05	10	191	4	315	25	56	ZH25-22
501100070	19.05	15	286	4	410	25	56	ZH25-22
501100071	19.05	25	476	4	600	25	56	ZH25-22
501100072	19.05	35	667	4	790	25	56	ZH25-22
501100073	19.50	10	195	4	320	25	56	ZH25-22
501100074	19.50	15	293	4	420	25	56	ZH25-22
501100075	19.50	25	488	4	615	25	56	ZH25-22
501100076	19.50	35	683	4	810	25	56	ZH25-22
501100077	20.00	10	200	4	325	32	60	ZH32-10
501100078	20.00	15	300	4	425	32	60	ZH32-10
501100079	20.00	25	500	4	625	32	60	ZH32-10

Part No.	Drill-Ø	Drilling depth		Point	Length	Driver Weldon		
	DC mm	ULDR L/D	LU mm	PL mm	OAL mm	DCON mm	LSC mm	Order No.
501100080	20.00	35	700	4	825	32	60	ZH32-10
501100081	20.50							

### Information / Advantages

#### Information Stock program Deep hole drilling tools Type 01

- Modern high performance deep hole drilling tools Type 01 now available as new stock program.
- **Ex stock (subject to prior sale).**
- Dimensions ideally suited for machining centers with inner coolant supply.
- Type 01 stock tools are standard version with 2 guide pads.
- Driver Weldon as per DIN1835-B / DIN6535-HB.
- Type 01 stock tools **do not include inserts and guide pads - please order separately.**
- All screws and stop plate - where applicable - are included.

#### Advantages

- New, high-performance deep hole drilling tool with a modern, user-friendly design.
- Very high operational efficiency combined with optimum cutting capacity.
- **NEW:** High performance inserts with chip breaker **SP91** for high productivity and wide range of application.
- Various indexable insert chip breakers are available according to the processed material.
- No regrinding needed.
- Easy exchange of indexable inserts and guide pads on the machine. No need to adjust setting within  $\pm 0,01$  mm diameter.
- By using interchangeable parts, the drill head diameter may be adjusted within a range of 0.5 mm.
- Wide range of accessories available for use on machining centers and deep hole drilling machines.

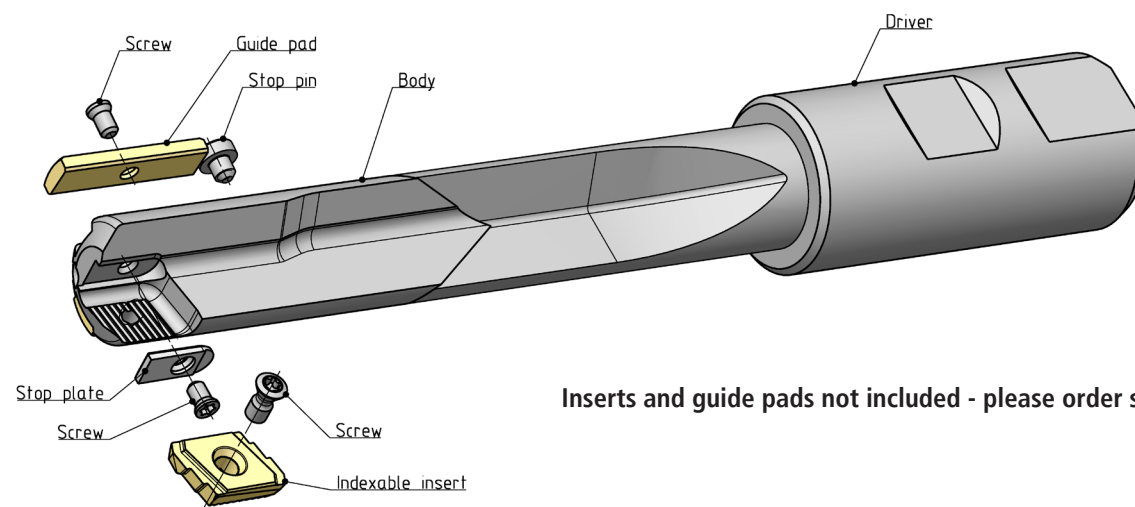

Inserts and guide pads not included - please order separately

For technical information and requirements for application, please refer to our catalogue "Deep hole drilling tools Type 01, 02, 07" for download at [www.botek.de](http://www.botek.de).

## Express production line / Stock program

#### Express production line:

specialized in manufacturing **certain tools quickly.**

Product range:

- Single flute gundrills / Twin fluted drills with brazed carbide tip **Type 110 / Type 120**
- Single flute gundrills in solid carbide design **Type 113**
- Single flute gundrills with indexable inserts and guide pads **Type 01**

#### Stock program:

- **Deep hole drilling tools Type 01**
- **New stock program for machining centers** with indexable inserts and guide pads
- **Single flute gundrills** with brazed carbide tip Type 110
- **Single flute gundrills** in solid carbide design Type 113 - **extended size range**

**More information regarding the Express order line and our stock program please see our homepage:**  
[www.botek.de](http://www.botek.de)

## Service

#### • Coating:

botek has its own coating facility. Depending on the processed material, coolant and drilling conditions, we offer the matching coating to suit your application.

#### • Regrinding:

We offer a prompt and cost effective in house regrinding service.

#### • Process layout / Process optimization:

Deep and precise drilling with high process reliability - we support you.  
We review your application and develop tailored tooling solutions that perfectly match your process conditions!

- Please see our application notes, [www.botek.de](http://www.botek.de)
- Our General Standard Terms and Conditions, which we assume as known, apply.
- We reserve the right to make modifications in the interests of technical improvement. Such modifications cannot, in principle, be accepted as justifiable grounds for complaint.
- Subject to change. The manufacturer accepts no responsibility for misprints and other errors.

© botek Präzisionsbohrtechnik GmbH

250 000 224/30-2016

## botek®

DEEP HOLE DRILLING SYSTEMS  
SOLID CARBIDE TOOLS

**botek**  
**Präzisionsbohrtechnik GmbH**

Längenfeldstraße 4  
72585 Riederich  
Germany

**P** +49 7123 3808-0  
**F** +49 7123 3808-138

**Info@botek.de**  
**www.botek.de**

**botek®**  
DEEP HOLE DRILLING SYSTEMS  
SOLID CARBIDE TOOLS

# Deep hole drilling tools Type 01 Stock program



## Single flute gundrills with indexable inserts and guide pads

